

审批
2024.03.05

Typhur

Typhur Dome

User Manual

v2.0

Typhur

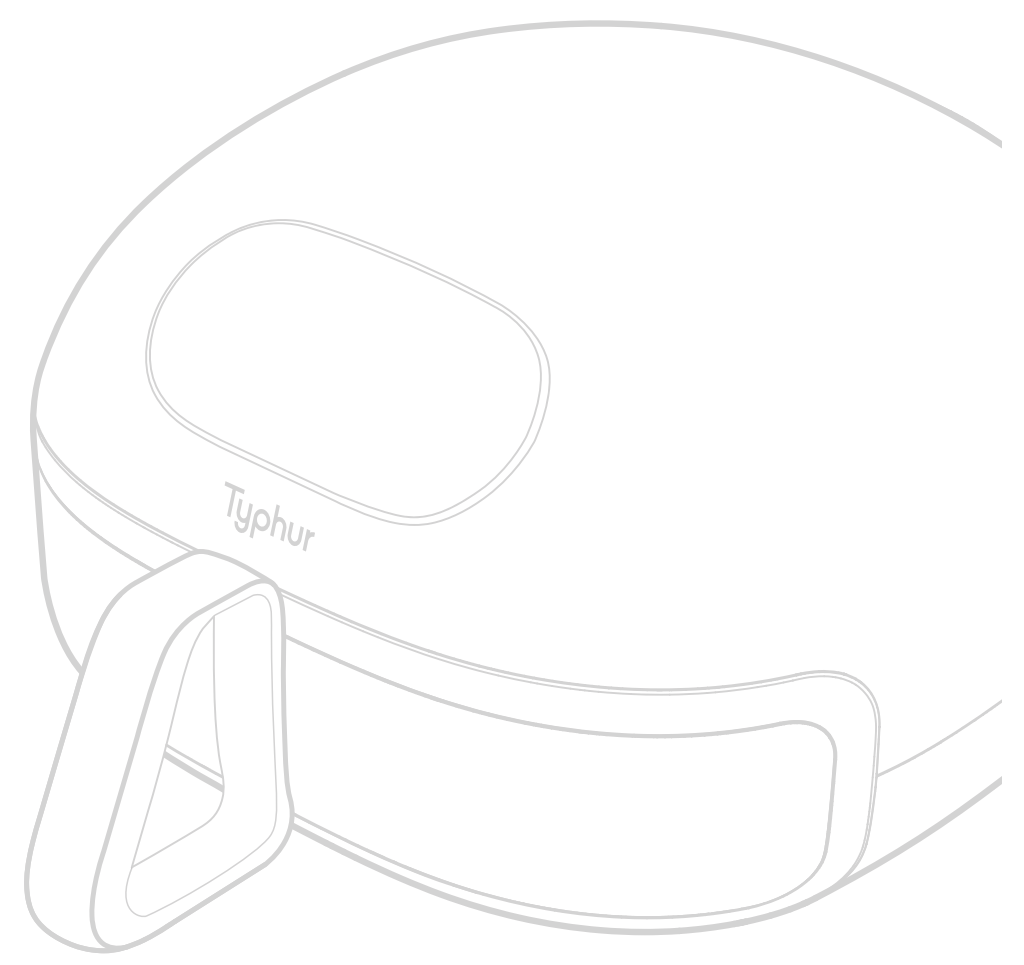

**Activate your 3-year warranty
within 30 days after purchase
with the QR code :**



Contents

Important Safeguards	P01
Using for the First Time	P03
Operation	P03
Cooking	P06
Self-Clean Mode	P12
Cleaning & Maintenance	P13
Troubleshooting	P14
Specifications	P15
Support	P16
Certification	P16

IMPORTANT SAFEGUARDS

When using electrical appliances, basic safety precautions should always be followed, including the following:

- Read all instructions carefully.
- **Do NOT** use outdoors.
- **Do NOT** touch hot surfaces. Use handles or knobs.
- **Do NOT** let the cord hang over the edge of a table or counter or touch hot surfaces.
- **Do NOT** place on or near a hot gas or electric burner or in a heated oven.
- **Do NOT** cover or block the air inlet or outlet openings while the appliance is operating.
- **Do NOT** fill the grill plate with oil or fat as this may cause smoke or a fire hazard.
- **Do NOT** put any amount of food that exceeds the maximum level indicated in the basket.
- **Do NOT** operate any appliance with a damaged cord or plug or after the appliance malfunctions or has been damaged in any manner. Return the appliance to the nearest authorized service facility for examination, repair, or adjustment.
- To protect against electrical shock, do not immerse the cord, plugs, or the main unit in water or other liquids.
- Close supervision is necessary when any appliance is used by or nearby children. Store the appliance in a safe place when not in use.
- Unplug from outlet when not in use and before cleaning. Allow to cool before attaching or removing any components.
- The use of accessory attachments not recommended by the appliance manufacturer may cause injuries.
- Extreme caution must be used when moving an appliance containing hot oil or other hot liquids.
- To disconnect, turn any control to "off", then remove plug from wall outlet. Do not use appliance for any purpose other than its intended use.
- Always put the ingredients to be fried in the basket, to prevent them from coming into contact with the heating elements.
- Ensure that no food is stuck in-between the basket and the interior of the Air Fryer. Contact Typhur's customer support team for help, repair and replacement.
- Extension cord:
 - a) A short power-supply cord is provided to reduce the risk resulting from becoming entangled or tripping over a longer cord.
 - b) Longer detachable power-supply cords or extension cords are available and may be used if care is exercised in their use.
 - c) If a longer detachable power-supply cord or extension cord is used:
 - 1) The marked electrical rating of the cord set or extension cord should be at least as great as the electrical

rating of the appliance;

- 2) The cord should be arranged so that it will not drape over the countertop or tabletop where it can be pulled on by children or tripped over unintentionally; and
- 3) If the appliance is of the grounded type, the cord set or extension cord should be a grounding-type 3-wire cord.

Save these Instructions.

Using for the First Time

1. Ensure that the voltage applied to the appliance matches your local or home voltage.
2. Remove plastic labels or stickers.
3. Place on a flat, horizontal level surface with safety clearance for air inlet and outlet.
4. Scan the QR code to download the free Typhur app for iOS or Android to control your device remotely.



Operation

Power Control

Press the **"power"** button to turn on and off the appliance.



Start/Pause Control

Press the **"Start/Pause"** button to start or pause cooking.



Temperature Unit Switch

Simultaneously press and hold the temperature buttons **"Up"** and **"Down"** for 2 seconds to switch the temperature unit between Celsius and Fahrenheit.

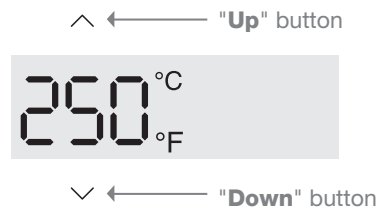

Preset Cooking Selection

To select a cooking preset temperature and time, press the corresponding button: **"Fries," "Wings," "Steak," "Bacon," "Frozen," "Air Fry," "Roast," "Broil," "Toast,"** or **"Dehydrate."**



App Control

To connect to Wi-Fi, press and hold the time control buttons **"Up"** and **"Down"** simultaneously for 2 seconds when the appliance is not cooking. The Wi-Fi icon will flash, indicating that the appliance is in pairing mode. Open the Typhur App on your smartphone or tablet. Tap on "Device" and Select "Add Device". Select Typhur Dome and follow the instructions to pair your device. After paired, pressing and holding the time control buttons "Up" and "Down" simultaneously for 2 seconds will unpair the current network address and prepare the appliance for new Wi-Fi pairing.

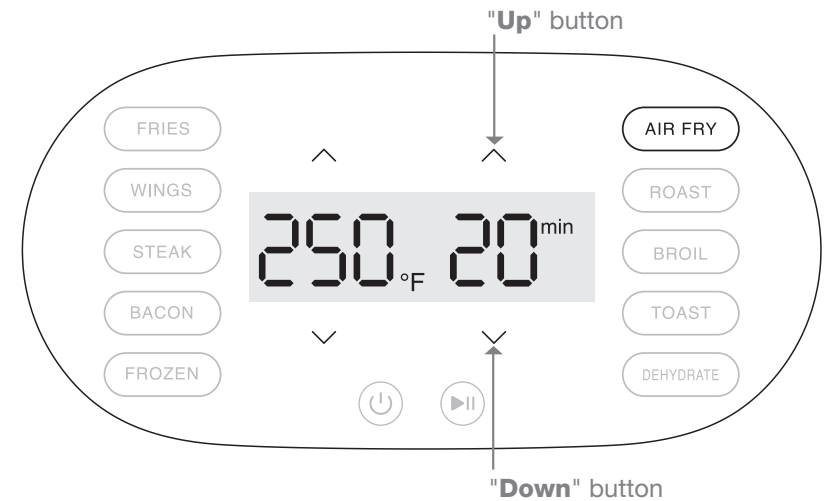

Preset Cooking Mode	Temperature (Default)	Time (Default)	Manual Temperature Setting Range (Min & Max)	Manual Time Setting Range (Min & Max)
Fries	350°F/175°C	16min	210°F/100°C - 450°F/230°C	1min - 60min
Wings	380°F/195°C	14min	210°F/100°C - 450°F/230°C	1min - 60min
Steak	450°F/230°C	6min	210°F/100°C - 450°F/230°C	1min - 60min
Bacon	400°F/205°C	10min	210°F/100°C - 450°F/230°C	1min - 60min
Frozen	375°F/190°C	20min	210°F/100°C - 450°F/230°C	1min - 60min
Air Fry (default)	355°F/180°C	15min	210°F/100°C - 450°F/230°C	1min - 60min
Roast	390°F/200°C	15min	210°F/100°C - 450°F/230°C	1min - 60min
Broil	450°F/230°C	10min	390°F/200°C - 450°F/230°C	1min - 60min
Toast	400°F/205°C	6min	210°F/100°C - 450°F/230°C	1min - 60min
Dehydrate	140°F/60°C	2hr	105°F/40°C - 250°F/150°C	1min - 24hr

- Preheating the appliance is recommended when cooking beef empanadas, steak, meatballs, pork chop, or seafood.
- Flipping halfway is recommended when cooking steak, meatballs, pork chops and toast.
- When preparing a larger amount of food, shake or stir the content in the basket in order to achieve a consistent result.

Cooking

Standard Procedure

1. Plug in a 120V power plug socket.

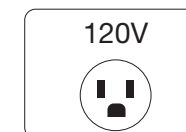

2. Remove the basket by pulling the handle.

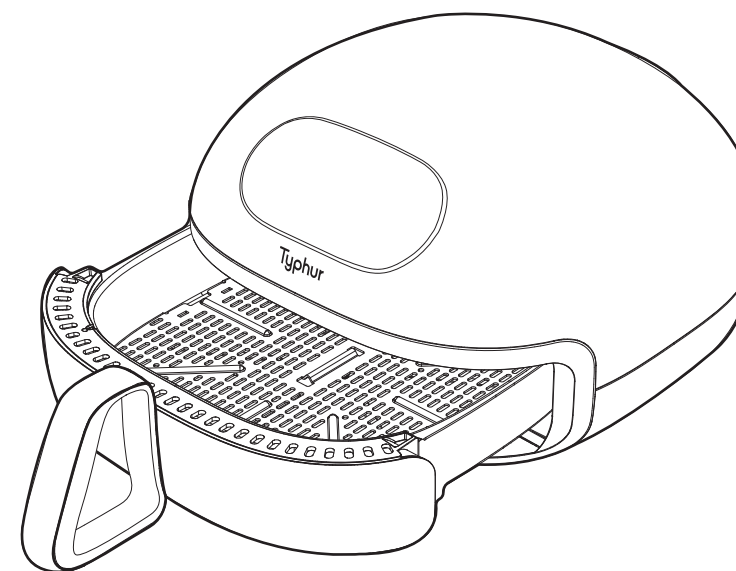

3. Put ingredients in the basket (do not exceed max amount).

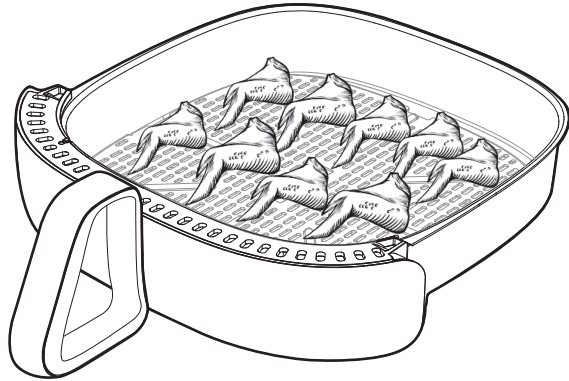

5. Press the **"Power"** button to turn on the appliance.

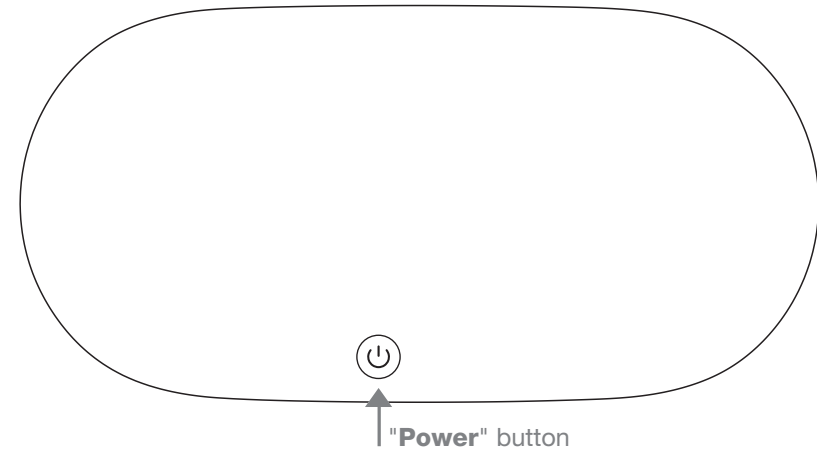

4. Insert the basket with the handle into the Air Fryer securely. The Air Fryer will not start cooking if the basket is not securely inserted. If this happens, the temperature and time display will show "---" and "--", respectively.

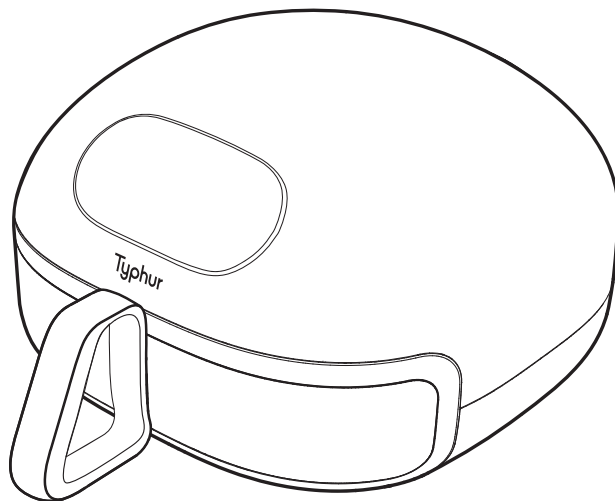

6. Press the **"Mode/Ingredient"** button to preset cooking temperature and time.
(The temperature and cooking time can be adjusted by pressing the "Up" and "Down" buttons, respectively)



7. Press the "Start/Pause" button to start the cooking process.

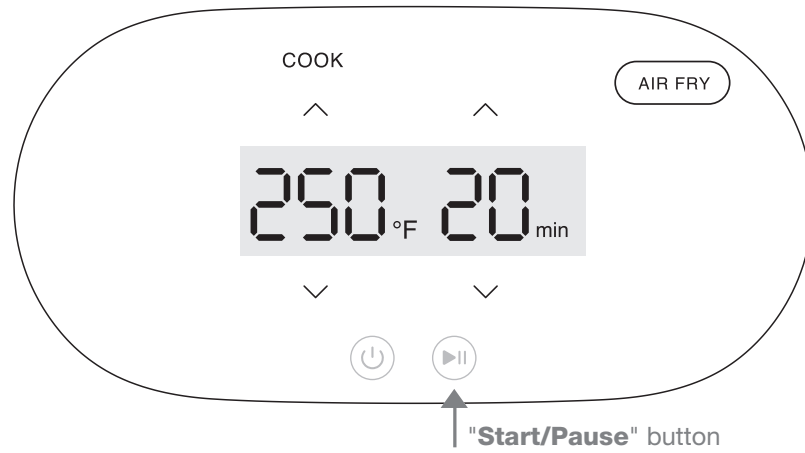

9. When paused, press the "Start/Pause" button to resume the cooking process.

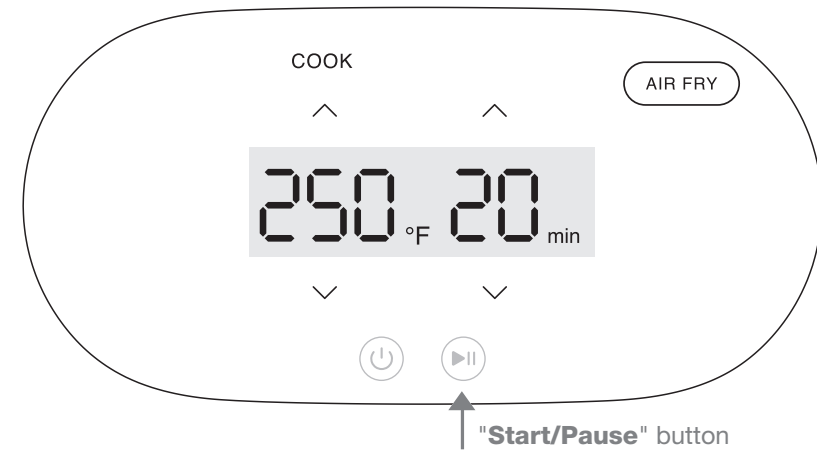

8. Press the "Start/Pause" button to temporarily pause the cooking process.
(The temperature and time settings can be adjusted during cooking)

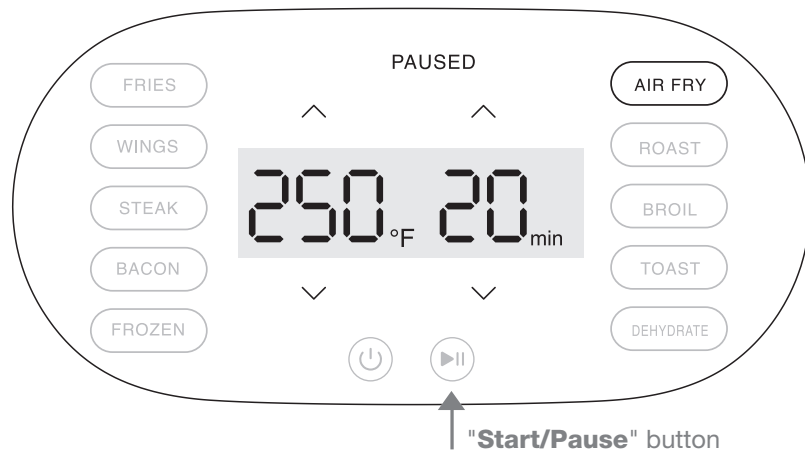

10. When cooking is completed, the appliance will emit three beeps to notify the user and automatically stop the cooking process.

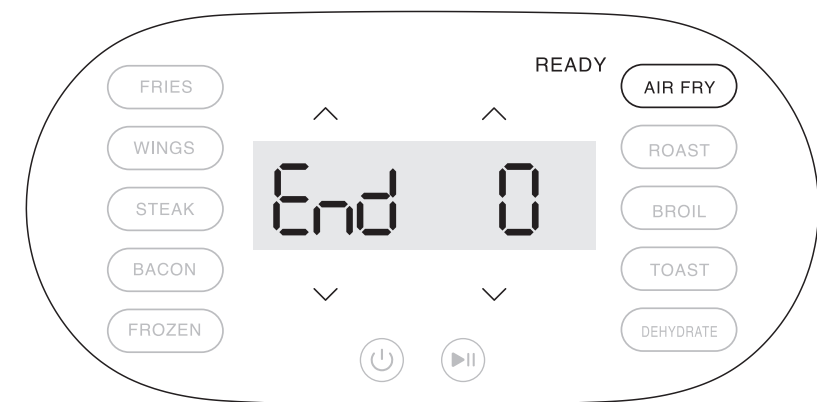

11. Remove the basket and allow the hot surface and food to cool before handling.

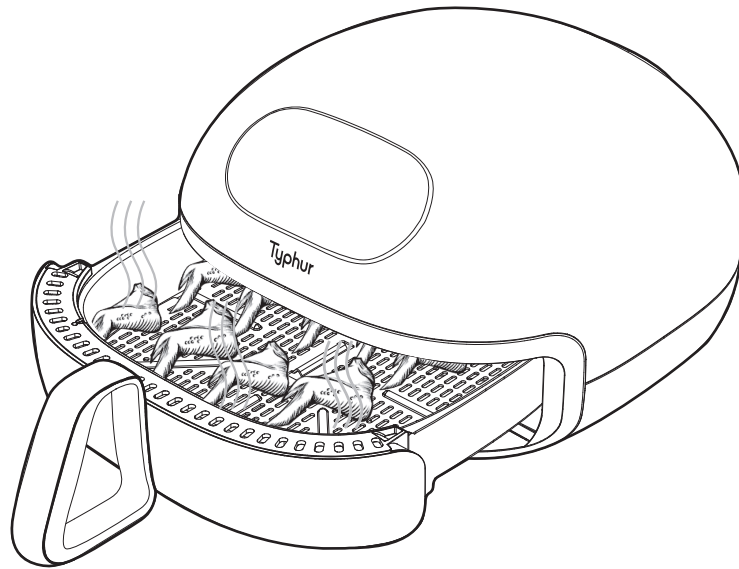

Stopping Cooking & Auto Shutoff

- The appliance will automatically pause the cooking process if the basket is pulled out during operation.
- The appliance will automatically power off after 20 minutes of inactivity in standby or paused mode.
- The appliance will only allow the "turn off" function if the fry basket is not detected inside. The temperature and time display will show "---" and "--", respectively.
- To ensure safety, the appliance will automatically shut down if it overheats during operation.

Self-cleaning Mode

Self-cleaning Mode can be used to remove oil and stains on the **Upper Part of the Internal Chamber**. It is advised to run Self-Clean Mode on a monthly basis.

- Before starting the cleaning process, dispose of any oil or leftovers from the basket.
- Open the Typhur App-Navigate to "Device Settings"-Tap "Self-cleaning" and follow the on-screen instructions.



APP

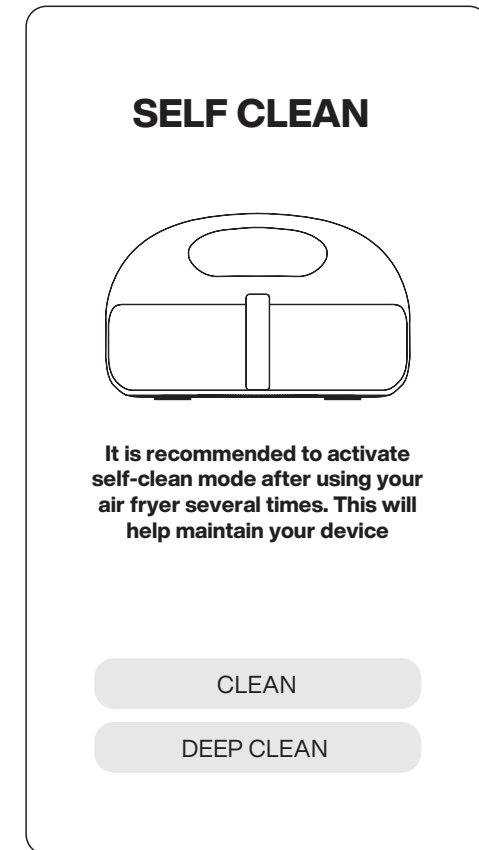

SELF CLEAN MODE

Cleaning & Maintenance

Always clean the appliance after every use.

- Turn off, unplug the appliance and wait for the appliance to cool down.
- The basket and plate are dishwasher safe. You can use baking soda mixed with water to remove grease.
- The appliance's surface should be wiped clean and dry, with particular attention paid to the control display.
- Clean the heating element with a soft brush to remove residues if necessary.

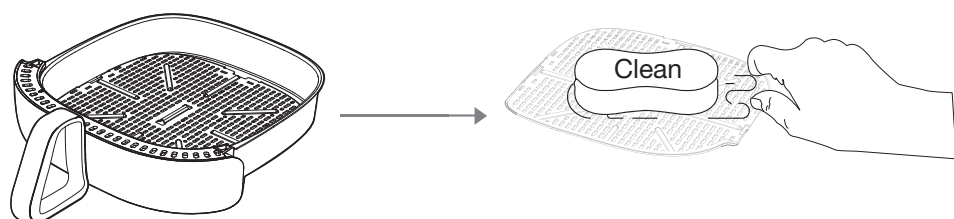

Note:

- The grill plate, the basket, and the inside of the appliance have a non-stick coating. Do not use metal kitchen utensils or abrasive cleaning materials as this may damage the non-stick coating.
- Make sure the appliance is clean and dry for storage.
- All other servicing should be performed by an authorized service representative.

Troubleshooting

Problem	Possible Cause	Solution
Does not switch on	Outlet supply overload	1. Check if the plug is inserted in the outlet properly 2. Try a different outlet and check the fuses
Smoke	1. Cooking fatty ingredients 2. Greasy residues	1. Carefully pour off excess oil or fat before resume cooking 2. Clean the pan and basket after each use
Display screen does not respond	Moist or liquid on display surface	Wipe out any moist or any other liquid immediately and always keep the display clean and dry
Display Error Code "E1" "E2" "E3"	The device is overheating	Switch off the device and unplug the power cord. Allow device to cool down to ambient temperature before switching back on. Contact customer service if the error code persists.
Display Error Code "E4" "E5" "E6" "E7" "E8" "E9" "E10"	Possible motor, sensor or communication failure	Switch off the device, disconnect the power supply, wait briefly, reconnect the power supply, and proceed to switch on the device again. Contact customer service if the error code persists.
Display Error Code "E11"	Abnormal voltage input	Please confirm the power input is 120V AC

Specifications

Model	AF03
Grill Plate Area	12 × 12 in
Power Supply	AC 120V, 60Hz
Rated Power	1,750W
Temperature Range	105°F~450°F
Capacity	5.6 qt
Weight	20.5 lb
Dimensions (including handle)	19.7 × 15.6 × 9.6 in
Dimensions (not including handle)	15.6 × 15.6 × 9.6 in

Terms of Service

For details about Typhur Terms of Service, please visit www.typhur.com/terms-of-service

Refund & Return Policy

Typhur has a 30 calendar days hassle-free return policy. For more details please visit www.typhur.com/refund-and-return

Limited One-Year Warranty

This appliance carries a limited one-year warranty against defects from the date of purchase. Full details are stated in Typhur's warranty policy at www.typhur.com/warranty.

3-Year Warranty

Activate your 3-year warranty within 30 days after purchase with the QR code :



Full details are stated in Typhur's warranty policy at www.typhur.com/warranty

Support

Please contact our Customer Support Team if you have any questions.

☎ : 1(888) 838-6563(USA)

✉ : support@typhur.com

🌐 : www.typhur.com/contact-us (USA)

Typhur Privacy Statement

We value your privacy and personal data rights, and we, Typhur Inc. is the entity responsible for the collection, use, and disclosure of information under our Privacy Statement.

For more details, please visit <https://www.typhur.com/privacy-statement>.

Certifications

FCC Statement:

This equipment has been tested and found to comply with the limits for a Class B digital device, pursuant to part 15 of the FCC Rules. These limits are designed to provide reasonable protection against harmful interference in a residential installation.

This equipment generates uses and can radiate radio frequency energy and, if not installed and used in accordance with the instructions, may cause harmful interference to radio communications. However, there is no guarantee that interference will not occur in a particular installation. If this equipment does cause harmful interference to radio or television reception, which can be determined by turning the equipment off and on, the user is encouraged to try to correct the interference by one or more of the following measures:

- Reorient or relocate the receiving antenna.
- Increase the separation between the equipment and receiver.
- Connect the equipment into an outlet on a circuit different from that to which the receiver is connected.
- Consult the dealer or an experienced radio/TV technician for help.

Caution:

The user is cautioned that changes or modifications not expressly approved by the party responsible for compliance could void the user's authority to operate the equipment.

FCC Radiation Exposure Statement:

This equipment complies with FCC radiation exposure limits set forth for an uncontrolled environment. This equipment should be installed and operated with minimum distance 20cm between the radiator & your body.

FCC Supplier's Declaration of Conformity

Product Name: Typhur Dome Air Fryer

Model Number: AF03

Suppliers Name: Typhur Inc.

Suppliers Address (USA) : 2890 Zanker Rd, Suite 120, San Jose, CA 95134

Suppliers Email: allen.f@typhur.com

ISED statement:

This device contains license-exempt transmitter(s)/receiver(s) that comply with Innovation, Science and Economic Development Canada's license-exempt RSS(s).

Operation is subject to the following two conditions:

1. This device may not cause interference.
2. This device must accept any interference, including interference that may cause undesired operation of the device.

L'émetteur/récepteur exempt de licence contenu dans le présent appareil est conforme aux CNR d'Innovation, Sciences et Développement économique Canada applicables aux appareils radio exempts de licence. L'exploitation est autorisée aux deu conditions suivantes :

- 1.L'appareil ne doit pas produire de brouillage;
- 2.L'appareil doit accepter tout brouillage radioélectrique subi, même si le brouillage est susceptible d'en compromettre le fonctionnement.

ISED Radiation Exposure Statement:

This equipment complies with ISED RSS-102 radiation exposure limits set forth for an uncontrolled

environment. This equipment should be installed and operated with a minimum distance of 20cm between the radiator and any part of your body.

Pour se conformer aux exigences de conformité CNR 102 RF exposition, une distance de séparation d'au moins 20 cm doit être maintenue entre l'antenne de cet appareil et toutes les personnes.

